

SOUTH 137TH EAST AVE.

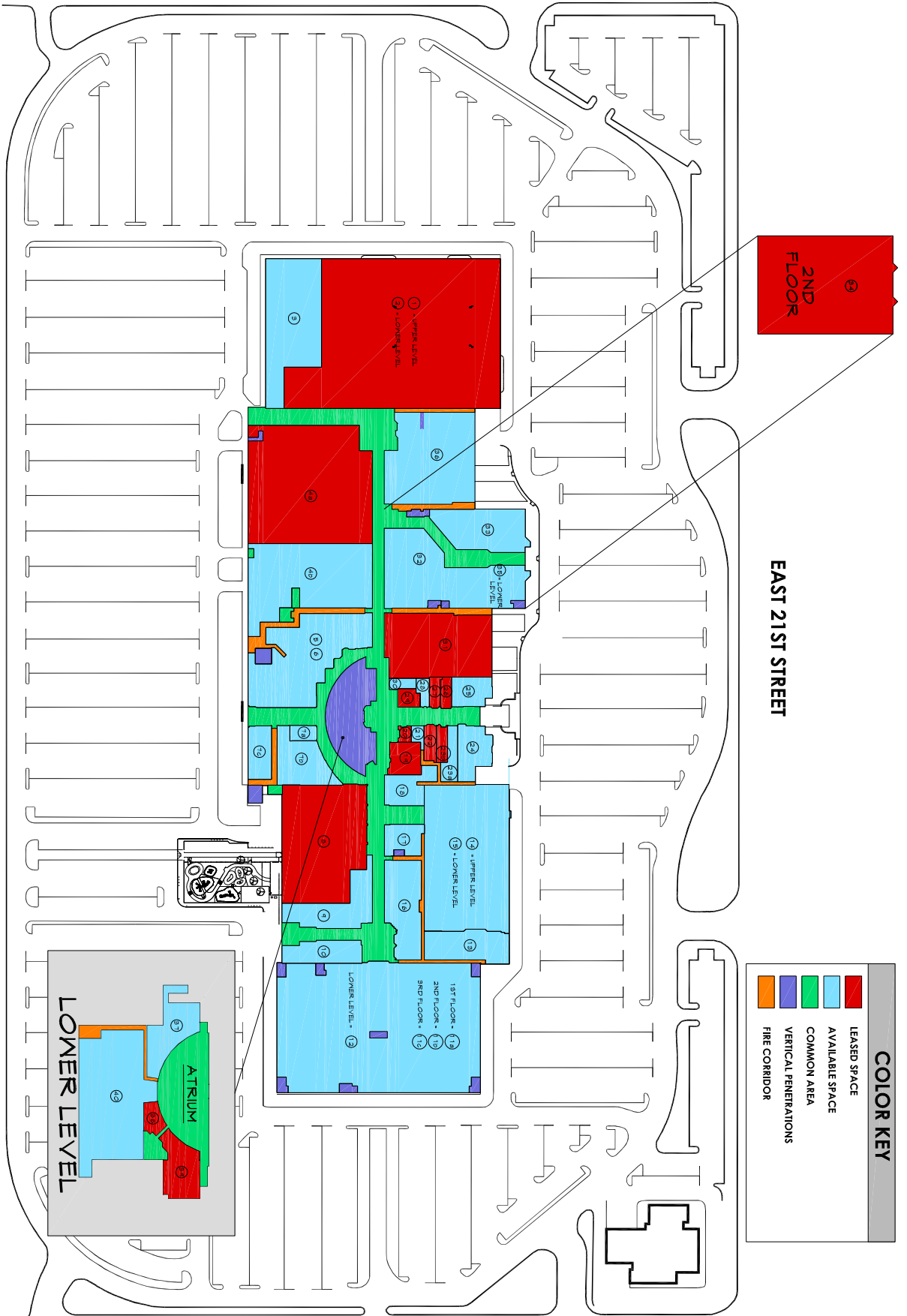

2ND FLOOR

EAST 21ST STREET

COLOR KEY

- LEASED SPACE
- AVAILABLE SPACE
- COMMON AREA
- VERTICAL PENETRATIONS
- FIRE CORRIDOR

A LEASE PLAN

NO.	DESCRIPTION	AREA
1	GCE	84710254
2	LOWER LEVEL - VACANT	18,100,90
3	VACANT	21,607,16
4	ALORCA	45,915,97
48	VACANT	25,545,73
49	VACANT	25,724,30
5/6	VACANT	17,020,24
76	VACANT	17,020,24
78	VACANT	3,940,54
79	VACANT	3,940,54
8	CARTIC	20,154,25
9	VACANT	43,124,48
10	VACANT	5,516,75
118	1ST FLOOR - VACANT	80,655,91
119	2ND FLOOR - VACANT	80,637,46
11C	3RD FLOOR - VACANT	80,941,30
12	LOWER LEVEL - VACANT	14,078,47
13	VACANT	8,070,41
14	VACANT	9,218,70
15	LOWER LEVEL - VACANT	10,927,41
16	VACANT	10,927,41
17	VACANT	9,581,51
18	VACANT	4,571,27
19	WESTSTAR	9,273,95
20	IBC	6,238,66
21	VACANT	1,55,85
22	CALL PRONAL	1,441,56
23B	VACANT	2,202,75
23B	MGRSE LAW FIRM	1,272,72
24	VACANT	5,194,34
25	VACANT	3,614,51
26	WBBVA	1,042,10
27	DELICIAS PIZZA	1,042,10
28	VACANT	1,032,46
29	KAFFE BONA	1,282,29
30	VACANT	91,256
31	WORKFORCE - OK	21,417,55
32	VACANT	24,450,31
33	VACANT	11,394,59
34	UNIVERSITY OF PHOENIX	30,049,00
35	LOWER LEVEL - VACANT	23,402,98
36	VACANT	24,665,95
37	VACANT	2,077,58
38	DISPENSARY SANDRIES	1,182,24
39	VACANT	1,182,24
40	MOVIE THEATRE	33,437,34

SOUTH 145TH EAST AVE.

EASTGATE METROPLEX

Kirtlow, Keith & Todd, Inc.
 architectural interior engineering
 TEL 918.744.4270
 FAX 918.744.7849
 2200 south wilco place, suite 200
 tulsa, oklahoma 74114
 www.ktarchitects.com



SCALE	DATE	BY	CHKD	APP'D
1/8"=1'-0"	10/20/08	DAW	JK	JK

UPPER AS-BUILT PLAN A-1